



Manually Tunable Band Pass Filter WTBCGV5-670-770-10-50-40SSK

Range 670 to 770 MHz Bandwidth 10 MHz Slopes 20 MHz Attenuation 40 dB min.

Passband	10 MHz bandwidth tunable from 670 to 770 MHz
Insertion Loss	1.5 dB max. at Fo (2 dB max. at Corners)
Return Loss	14 dB min. (VSWR 1.5:1 max.)
Stopband	DC to Fo - 25 MHz and Fo + 25 to 1750 MHz
Stopband Attenuation	40 dB min.
Operating Temperature	15 °C to 45 °C
Power Handling	will be quoted on request (See our warranty)
Dimensions (L x W x H)	max. 175 x 30 x 125 mm (connectors may protrude)
Approx. Weight	0.8 kg
Mounting Provision	10 mm flanges on both ends with 3.3 mm holes
Connector 1	SMA - Female
Connector 2	SMA - Female
Tuning	Tuning with knobs

Typical Performance

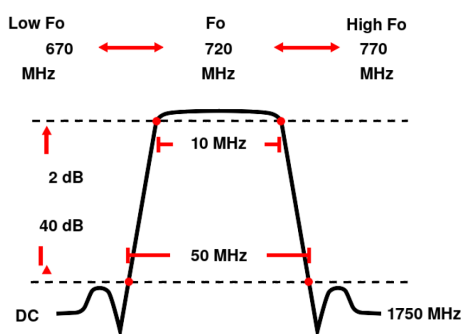

5 Section Cavity Design



Technical drawing

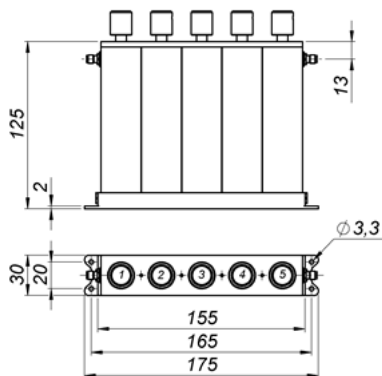

Connector Options:

SMA - Female
SMA - Male
N - Female
N - Male
BNC - Female
BNC - Male

Unit prices

1-4 pieces
1990 €

5-9 pieces
1891 €

10-24 pieces
1791 €

25-49 pieces
1692 €

50-99 pieces
1592 €

100+ pieces
1493 €

Delivery Terms

FCA Andechs (free carrier) according to Incoterms 2020. Regarding payment terms and warranty see Terms and Conditions. Delivery time: normally 4 to 6 weeks - depending on quantity ordered and on our work load. **Customer is responsible for observing all applicable export laws in regard to filter application and location of end user.**

Wainwright Instruments GmbH
Graf-Rasso-Street. 1
82346 Andechs
Germany

Contact
Phone: +49 (0) 8152 918230
Telefax: +49 (0) 8152 918255
Email: info@wainwright-filters.com

Legal notes
Managing director: Terence Wainwright
Registering court: Amtsgericht München Abt.B Nr. 58192
VAT Id number: DE 128249711