



Band Pass Filter

WBCTV4-451.5-459.5-460.5-468.5-50SS

Passband 459.5 to 460.5 MHz Slopes 8 MHz Bandwidth 1 MHz Attenuation 50 dB min.

Passband	460 (Fo) \pm 0.5 MHz = 459.5 to 460.5 MHz
Insertion Loss	1.25 dB max. at Fo (1.5 dB max. at Corners)
Return Loss	14 dB min. (VSWR 1.5:1 max.)
Stopband	DC to 451.5 MHz and 468.5 to 1200 MHz
Stopband Attenuation	50 dB min.
Operating Temperature	15 °C to 45 °C
Power Handling	will be quoted on request (See our warranty)
Dimensions (L x W x H)	max. 275 x 60 x 170 mm (connectors may protrude)
Approx. Weight	3.6 kg
Mounting Provision	17.5 mm flanges on both ends with 4.5 mm holes
Connector 1	SMA - Female
Connector 2	SMA - Female

Typical Performance

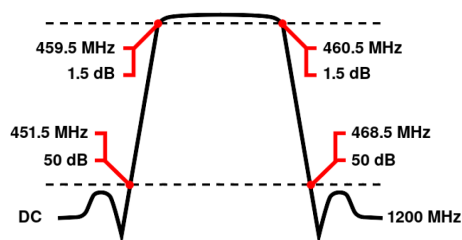

4 Section Cavity Design



Technical drawing

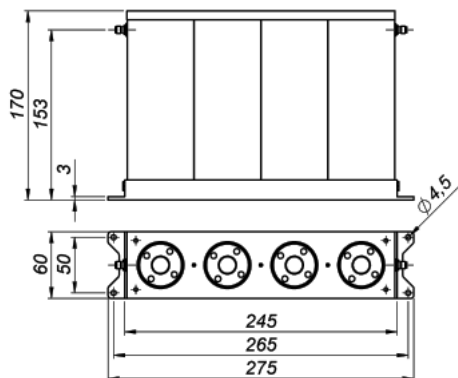

©2013 Wainwright Instruments. All rights reserved.

Connector Options:

SMA - Female
SMA - Male
N - Female
N - Male
BNC - Female
BNC - Male
7/16" - Female

Unit prices

1-4 pieces
2090 €

5-9 pieces
1986 €

10-24 pieces
1881 €

25-49 pieces
1777 €

50-99 pieces
1672 €

100+ pieces
1568 €

Delivery Terms

FCA Andechs (free carrier) according to Incoterms 2020. Regarding payment terms and warranty see Terms and Conditions. Delivery time: normally 4 to 6 weeks - depending on quantity ordered and on our work load. **Customer is responsible for observing all applicable export laws in regard to filter application and location of end user.**

Wainwright Instruments GmbH
Graf-Rasso-Street. 1
82346 Andechs
Germany

Contact
Phone: +49 (0) 8152 918230
Telefax: +49 (0) 8152 918255
Email: info@wainwright-filters.com

Legal notes
Managing director: Terence Wainwright
Registering court: Amtsgericht München Abt.B Nr. 58192
VAT Id number: DE 128249711