

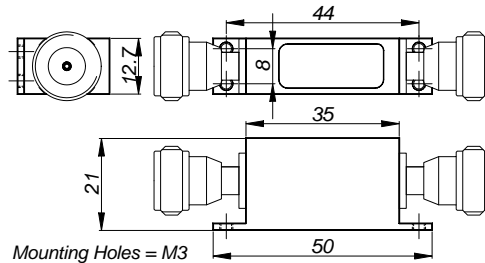

**Wainwright
Instruments GmbH**

Widdersberger Str.14
82346 Andechs, Germany
 Tel.: +49-8152-918230 Fax: +49-8152-918255
 E-Mail: info@wainwright-filters.com
 Internet: www.wainwright-filters.com

Fco between 500 and 1000 MHz	Highpass Stock* Filters Cauer (Elliptic) Design C7/40**	WHJS Series: 21 mm high
--	--	--

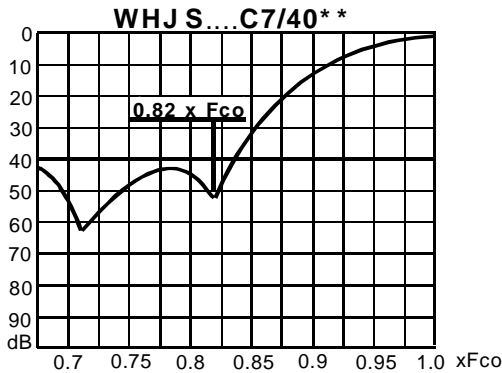

Connector Codes:**
 E (N-female) F (N-male) S (SMA-female) T (SMA-male)

Return Loss (50 Ω) in Passband - at the worst point
Filters up to 224 MHz Fco: 14 dB min. = VSWR 1.5 : 1 max.
Filters 225 to 1000 MHz Fco: 12 dB min. = VSWR 1.67 : 1 max.

Model Number	Passband MHz	Max. Insertion Loss			Reject Attenuation 40 dB min. from DC to 0.82 x Fco =
		at Fco	at 1.03 x Fco	at 1.1 x Fco	
WHJS 500 C7/40**	500,00 to 3000	0,70 dB	0,60 dB	0,50 dB	DC to 410,0 MHz
WHJS 550 C7/40**	550,00 to 3000	0,70 dB	0,60 dB	0,50 dB	DC to 451,0 MHz
WHJS 600 C7/40**	600,00 to 4000	0,70 dB	0,60 dB	0,50 dB	DC to 492,0 MHz
WHJS 650 C7/40**	650,00 to 4000	0,70 dB	0,60 dB	0,50 dB	DC to 533,0 MHz
WHJS 700 C7/40**	700,00 to 4000	0,70 dB	0,60 dB	0,50 dB	DC to 574,0 MHz
WHJS 750 C7/40**	750,00 to 4000	0,70 dB	0,60 dB	0,50 dB	DC to 615,0 MHz
WHJS 800 C7/40**	800,00 to 4000	0,70 dB	0,60 dB	0,50 dB	DC to 656,0 MHz
WHJS 850 C7/40**	850,00 to 4000	0,70 dB	0,60 dB	0,50 dB	DC to 697,0 MHz
WHJS 900 C7/40**	900,00 to 4000	0,70 dB	0,60 dB	0,50 dB	DC to 738,0 MHz
WHJS 950 C7/40**	950,00 to 4000	0,70 dB	0,60 dB	0,50 dB	DC to 779,0 MHz
WHJS 1000 C7/40**	1000,00 to 4000	0,70 dB	0,60 dB	0,50 dB	DC to 820,0 MHz

Filters with cut-off frequencies that are not listed above:

Choose any Fco between 500 MHz and 1000 MHz and assign a **Model Number** by inserting the desired Fco.
Example: The Model Number of a 7 degree / 40 dB Cauer Highpass Filter with a cut-off frequency of 525 MHz is **WHJS 525C7/40SS**. The insertion loss and dimensions of the listed **lower** frequency see **WHJS 500C7/40SS**.

PRICES (each)	EURO ¹⁾	US-\$
1 to 4 filters	364	<i>Will be quoted.</i>
5 to 9 filters	328	
10 to 24 filters	295	
Test Data Sheets:	10	
Netw. Analyzer Curves:	15	
Cert. of Conformance:	supplied	

1) **Delivery Terms:** FCA Andechs-Frieding (free carrier) according to **Incoterms 2000**
 In Deutschland liefern wir frachtfrei gemäß CPT **Incoterms 2000** (unversichert).

Regarding payment terms and Warranty see [Terms and Conditions](#)

Delivery Time: normally 3 to 4 weeks - depending on quantity ordered and on our work load at time of order.

*) **STOCK* FILTERS** carry an "S" in the model number (i.e. WHJS 10C7/40SS). Such filters are either in stock or can be built quickly from prepared assemblies. The filters are guaranteed to meet the specifications shown in the data sheets. Certificate of Conformance supplied. Prices for Test Sheets see above