



**Wainwright  
Instruments GmbH**

Widdersberger Str.14  
**82346 Andechs, Germany**  
 Tel.: +49-8152-918230 Fax: +49-8152-918255  
 E-Mail: [info@wainwright-filters.com](mailto:info@wainwright-filters.com)  
 Internet: [www.wainwright-filters.com](http://www.wainwright-filters.com)

**6 Resonator  
Cavity Design  
WBCG Series**

**Tunable Bandpass Filter**  
**Frequency Range 2500 MHz to 3100 MHz**  
**Passband Bandwidth 52 MHz**

**Model No.**  
**WBCG 2500/3100-  
52/40-6**  
 (add codes - see below)

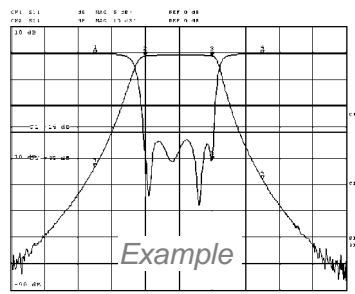

Tuned to the low end

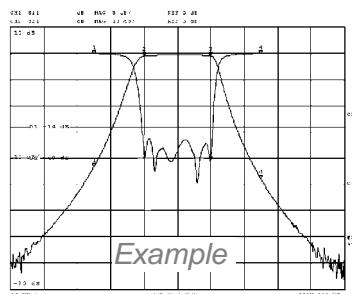

Tuned to 2800 MHz

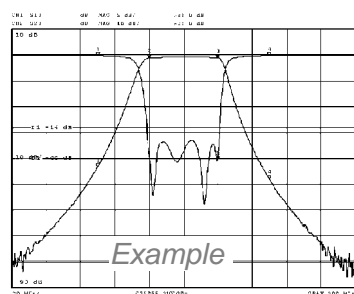

Tuned to the high end

Model: **WBCG 2500/3100-52/40-6SSK**

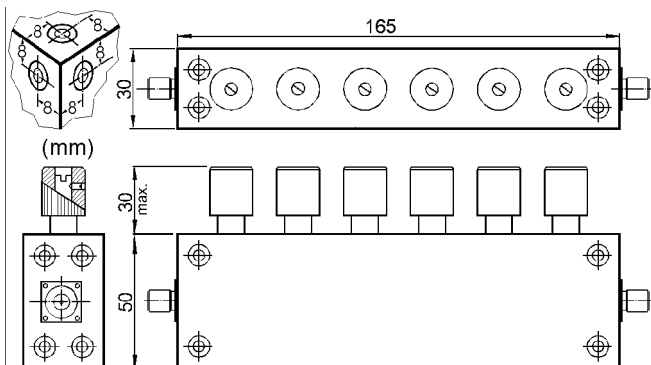

Screwdriver adjustment possible from slot in knob.  
 Knob can be removed or made ineffective by loosening the set screw.

Specifications		<b>Dear Customer:</b> Please help us serve your needs more precisely: Please let us know what power handling is most desirable for your application and what bandwidth (in MHz) would be the most useful for you in this frequency range.
<b>Passband:</b>	52 MHz (nominal)	
<b>Passband Loss:</b>	1.5 dB max. at Fo / 2.0 dB max. at corners	
<b>Power Handling:</b>	Not yet determined	
<b>Return Loss (50Ω) in Passband:</b>	14 dB min. = VSWR 1.5 : 1 max.	
<b>Reject Attenuation:</b>	40 dB min. at 2800 MHz ± 60 MHz	
<b>Stopband:</b>	60 dB to at least 7840 MHz	
<b>Operating Temperature:</b>	+15°C to +45°C	
<b>Dimensions:</b>	50 mm high x 30 x 165 mm (plus connectors and knobs)	
<b>Approx. Weight:</b>	0.5 kg (1.1 lbs)	
<b>Mounting Provision:</b>	4 x M4 threaded holes each on all sides	
<b>Connector Code:</b>	SMA-female = <b>SS</b> or N-female = <b>EE</b>	
<b>Options Codes:</b>	Filters with tuning knobs = <b>K</b> - filters with slots for screwdriver tuning = <b>SD</b>	
<b>Prices:</b> When purchasing 1 - 4 pcs.	<b>Euro: € 976,--</b>	<b>US-\$: <u>Will be quoted.</u></b>
<b>Delivery Terms:</b>	FCA Andechs-Frieding (free carrier) according to <b>Incoterms 2000</b> . In Deutschland liefern wir frachtfrei gemäß CPT <b>Incoterms 2000</b> (unversichert). Regarding payment terms and Warranty see <a href="#">Terms and Conditions</a> .	
Test Sheet with Analyzer Curves supplied		
<b>Delivery Time:</b> Will be quoted		